

Instruction Manual

Submersible Water Pump
WP600, WP880, WP1050, WP1200

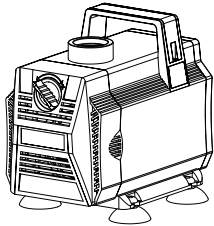

WP600/800

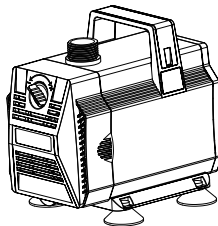

WP1050/1200

Thanks for buying our pump. To ensure you use the pump safely and correctly, please read carefully and thoroughly this instruction.

Please note that we are not responsible for any failure caused by misuse or improper maintenance.

Save this instruction for future use.

Important Safety Cautions

1. Please operate the appliance under the rated voltage and frequency indicated on the rating label or instruction manual.
2. A 10mA or 30mA residual current device must be fitted to the mains supply.
3. The power cord is not replaceable. If the power cord or the plug is found hurt or damaged, or the plug is found aged, stop using the pump immediately. Return the pump to the retailer / distributor for disposal, or dispose it by yourself.

Do not attempt to shorten the power cord, or to remove the plug. Failure to meet this point may cause damage to the pump.
4. If abnormal smell or noise is found to the pump, unplug it immediately and check the cause. Contact your retailer / distributor if needed.
5. Make sure your hand and the plug are dry when plug in or unplug the pump. It is forbidden to plug or unplug the pump with a wet hand as this might cause electric shock.
6. Unplug the pump before installation and cleaning. Don't pull the power cord abruptly. To unplug, grasp the plug and pull it out from the receptacle.
7. Protect properly the pump. If severe collision happens to the pump, check if there is any damage. If there is any breakage, stop using the pump and destroy it.
8. Do not let the pump run dry as this will damage the rotor and will cause over-heating of the motor.
9. Do not operate or leave the pump in freezing conditions.
10. Do not use the pump in inflammable or corrosive liquids. The pump should work in the environment less than 35 °C (95F).

Thermal Overload Protection

This pump is configured with automatic thermal overload protection. If the motor overheats, the protection device will cut off the power automatically. If this occurs, switch off the power at the mains supply to the pump. Check for the cause. Usually, it will be debris blocking the inlets of the pump or obstructing the impellor. Remove the obstruction and wait for 15 minutes. When the motor cools down, switch on the pump and the motor will start working again.

Product Structure Diagram

WP600/WP880

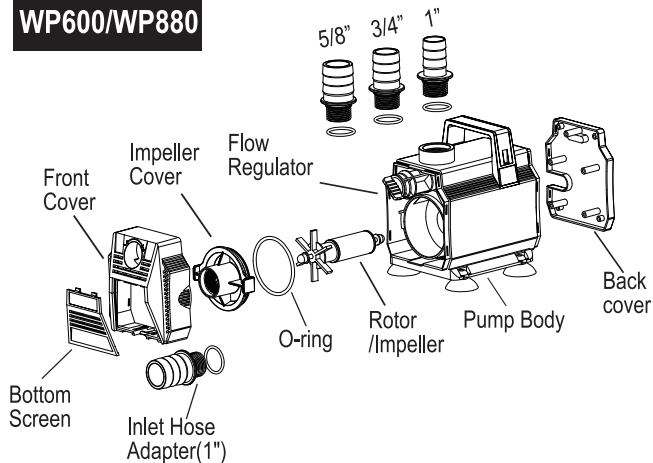

WP1050/WP1200

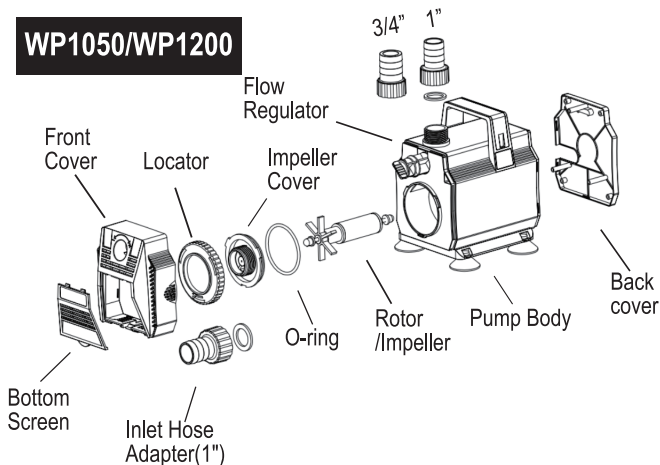

Operation

This pump can be used in 2 ways: submersible and in-line.

Submersible Use – simply choose the desired hose adapter, screw into the outlet of the water pump, and connect to the hose (to be obtained separately), then plug in to start the operation.

In-line Use – pull the tab at the bottom of the front cover to detach the lower screen from the front cover, fit the 1" adapter (the one with the largest opening) to the inlet of the impeller cover, then connect the hose to adapters on both the inlet and outlet end.

KIND REMINDER – DO NOT USE THE PUMP IN-LINE FOR LONG TIME. Otherwise, the pump motor may get too hot to trigger the thermal protection and the pump will stop working. In this case, unplug the pump, wait for at least 15 minutes to let the motor cool down, then connect to the mains supply again.

Flow Regulator – The flow rate of this pump can be adjusted by turning the flow regulator on the front cover.

Maintenance

This pump is free from lubricants or special maintenance. However, to keep the pump operates in the best condition, regular maintenance and cleaning is needed.

Do not pull the power cord to lift the pump as this may cause damage. It is recommended to fit a lifting cord to the pump when the pump is installed in deep water.

To clean the pump,

1. Remove by pulling the front cover off from the pump body.
2. Remove the impellor cover by turning counterclockwise to release the lock. Gently pull away the impellor cover from the motor body. Make sure the O-rings are not missed.

3. Carefully take out the impellor/rotor assembly.
4. Wash out all of the components in clean water. Do not use detergents or other chemical cleaners.
5. Reassemble the pump in the reverse order.

-Clean the pump at least once a month. More frequent cleaning might be needed depending on the water condition.

-For wearing parts like the impellor kit, approach the local retailer / distributor for replacement. You need to pay for the wearing parts if the pump has been used for over 1 year.

Troubleshooting

The pump doesn't pump water

- The pump is not started up.
- The power doesn't match the voltage and frequency specified on the pump.
- Water inlet or outlet is blocked.
- Impellor or rotor is damaged.

Water flow is reduced

- The voltage is lower than the rated voltage.
- Water inlet or outlet is partially blocked.
- Wastes are accumulated in the filtering system.

The pump is noisy

- Water inlet is partially blocked.

-Water level is lower than the inlet of the pump. Air enters into the pump to cause noise.

-Rotor is worn (need to be replaced)

Seek for your local retailer / distributor's help if the above troubleshooting can't resolve the problems.

Water Pump Specifications

| Model | WP600 | WP880 | WP1050 | WP1200 |
|-----------------|----------------------------|--------|----------------------|---------|
| Freq./Volt. | 120V/60Hz | | | |
| Power | 35W | 45W | 55W | 70W |
| Max. Flow | 600GPH | 880GPH | 1050GPH | 1200GPH |
| Max. Headheight | 7ft | 8ft | 9ft | 10ft |
| Hose Adapters | In-1", Out- 5/8", 3/4", 1" | | In-1", Out- 3/4", 1" | |